

Key:

Black text indicates no suspect ACM's visible at the time of survey.

Blue text indicates area presumed to contain ACM's

Red text indicates area confirmed or strongly presumed to contain ACM's

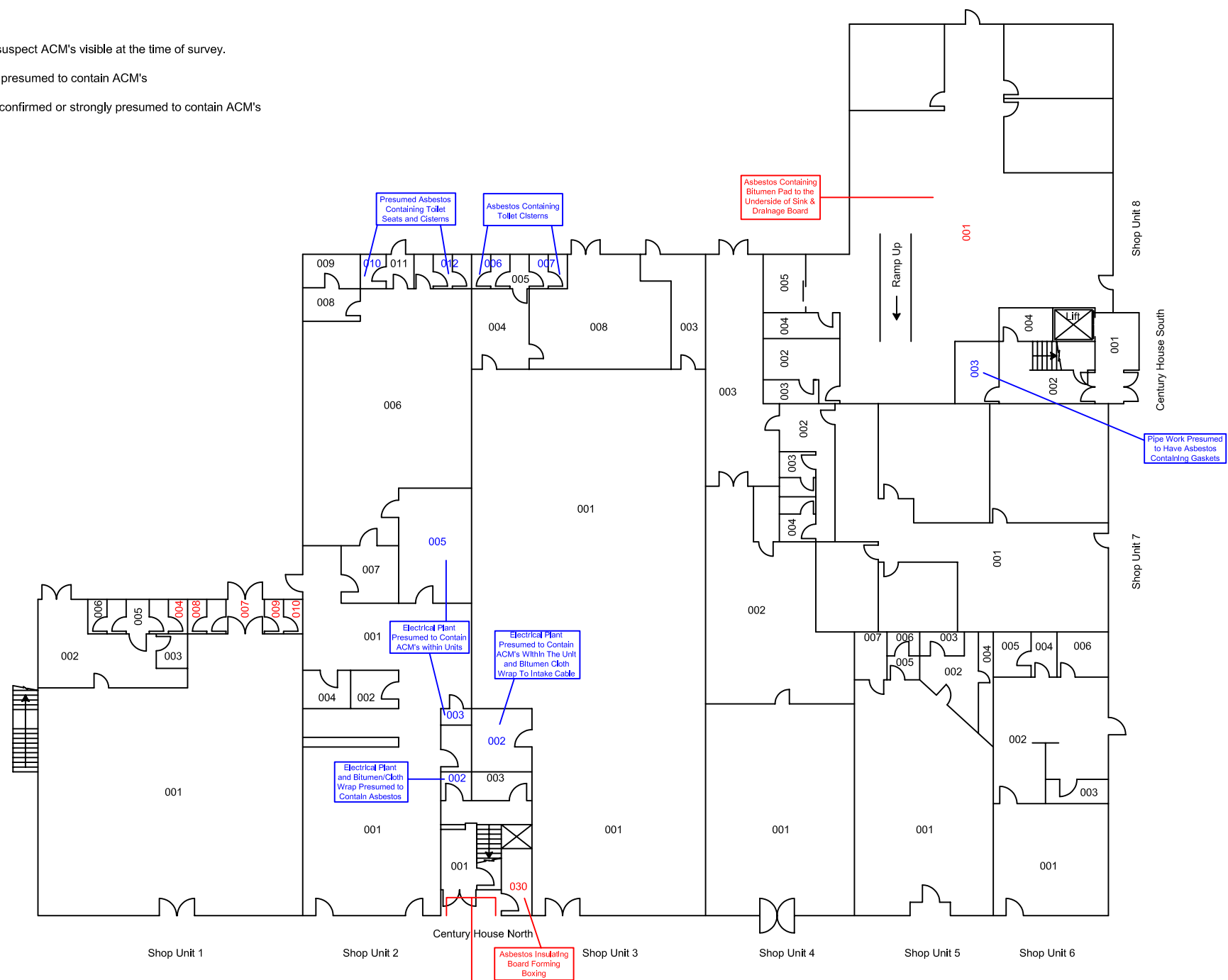

Ground Floor

<p>Upwards Direction of staircase</p>	<p>CAD Consultants :- The CAD Bureau Southern Ltd 7 Stonecrop Colchester Essex CO4 5LUG Tel/Fax 01206 366966 E-mail info@cad-bureau.com</p>	<p>Floor Level(s) Ground</p>	<p>Drawing Number S-001-A0064-G</p>
		<p>Address Century House Riverside Office Centre North Station Road Colchester</p>	<p>Drawn by - S Blackwell Checked by - Dan Cater Date :- 20th March 2003 Sheet 1 of 3 Scale - 1:200 @ A3 Size</p>